



[Home](#) | [Boats for Sale](#) | [Boat Loans](#) | [Insurance](#) | [Transport](#) | [Marine Directory](#) | [Charters](#)



"Sir Teady"

37' Lord Nelson Victory 37

- Year: 1985
- **Current Price:**
US\$ 199,900
- Located in Stuart, FL
- Hull Material: Fiberglass
- Engine/Fuel Type: Single Diesel
- YW# 10784-1489520
- **Inactive**

[Photo Gallery](#)

[Send Email](#)

[Finance It](#)

[Insure It](#)

[Ship It](#)

Additional Specs, Equipment and Information:

Builder/Designer

Builder: Lord Nelson

Designer: Jim Bachus

Dimensions

LOA: 37'

LWL: 33'4"

Beam: 13'2"

Displacement: 20,500

Draft: 3'6"

Bridge Clearance:

12'6"

Engines

Engine(s): Cummins

Engine(s) HP: 150

Hours: 1350

Cruising Speed: 7 knots

Max Speed: 9 knots

Tankage

Fuel: 250 gal.

Water: 185 gal.

Holding: 13 gal.



Stateroom

Introduction

"Sir Teady" has benefited from numerous custom upgrades and very light use. This 37' Lord Nelson Victory is based upon a traditional New England workboat hull. She is a long range cruiser with a yacht finished interior that goes well with her salty styling. "Sir Teady" was Built in Taiwan on a solid fiberglass, full displacement hull with plumb bow and a full length ballasted keel for great stability. Her single Cummins diesel allows for an honest cruising range of between 800 and 900 miles on 250 Gallons of fuel. Current owner has this vessel in Excellent condition!!!She



Head



Shower



Pilot house fwd.

is turn-key ready and awaits her new owners to continue her cruising portfolio. (New preliminary listing more to come)

Vessel Walkthrough & Accommodations

Beginning forward is the master stateroom featuring an offset queen, a hanging locker to port and a vanity with seat and mirror to starboard. The split head and shower follow next, moving aft. The head features a manual head. The shower on the starboard side features a sink, vanity and mirror. Both head and shower areas feature hot and cold water with separate sinks. Up a few steps and you're in the spacious pilothouse with 360 degree visibility. The bench seat pulls out converting to a single berth. Both port and starboard doors are split Dutch style, and the windows open for good ventilation. Going aft down a few steps, you're in the spacious galley/salon area. The U-shaped galley is to starboard and features a front loading refrigerator and freezer and an electric stove with oven and microwave. The salon has built-in seating that converts to a very comfortable double. The salon table is moveable and fastens to the sole in a number of locations. The cabinet in the galley swings open gaining full walk-in access to the engine room.

Galley

The U-shaped galley to port fills the forward end of the salon. The oversized refrigerator has top and side access and is built into the lower cabinet which also acts as a room divider. A 3-burner propane stove with oven is to port beneath a large window. There is plenty of counter space along the forward bulkhead as well as the double sinks. Ample cupboards and drawers provide utensil space. A large hanging locker cleverly opens to provide access to the engine.

- 12 volt Adler-Barber refrigeration
- Magic chef
- Sharp microwave
- 400 series AC/DC refrigerator



Pilot house aft

- 3 burner propane stove with oven
- Double stainless steel sinks
- Pressure water hot and cold
- freezer
- LP gas control
- LP gas storage in stack

Salon

"Sir Teady's" salon is spacious and comfortable. There are cornices with lined curtains on all windows, two leather chairs, velour L-shaped settee with storage under which converts to a double berth and a large fold out dining table.

- Bar with cabinate storage
- Bookshelves
- Freezer with custom cabinate
- Custom wall lights
- Direct TV box
- Samsung flat screen TV
- Barometer and clock
- Weems Plath
- Opening windows with screens



Helm

Engine/Mechanical Equipment

"Sir Teady's" walk-in engine room with additional access from the pilot house is home to the preferred Cummins 150 HP diesel. The engine has low hours and along with all other mechanical equipment has been professionally maintained.

- Cummins 150 HP FWC diesel engine
- Racor fuel filter
- Stainless steel hot water heater
- Vetus bow thruster
- Automatic/manual bilge pumps
- Spare parts



Galley

Electronics and Navigation Equipment

The electronics console is well laid out and offers great visibility for the helmsman. The pilothouse is bright and airy with wrap around windows and



Salon



Salon port

port & stbd entry/exit doors. A large pilot seat/berth is aft and offers great views for the captain or guest. The walls are finished in solid teak planking and the sole is teak and holly.

- Multifunction Raymarine C120 series electronics package 2005
- Color 48 mile radar
- Color Chart plotter
- Color depth sounder
- Navionics charts from Canada to Bahamas
- Raymarine ST 8001 Autopilot
- Raymarine 101 VHF hand held
- Standard GX2360S VHF with intercome/hailer
- Digital VHF antenna
- Maptech charts from Canada to Bahamas
- Ritchie compass
- KVH 33 Satellite phone
- Trac vision 4
- Kenwood AM/FM/CD/Sirius-ready radio with 4 speakers
- Samsung flat screen TV

Other

"Sir Teady" has benefited from numerous custom upgrades and very light use. Her quality is second to none and her design distinctive and guaranteed to turn heads in every harbor you enter. If you are lookin for a distinctive, "T OP OF THE LINE" unique trawler you owe it to yourself to experience "Sir Teady"

Disclaimer

The Company offers the details of this vessel in good faith but cannot guarantee or warrant the accuracy of this information nor warrant the condition of the vessel. A buyer should instruct his agents, or his surveyors, to investigate such details as the buyer desires validated. This vessel is offered subject to prior sale, price change, or withdrawal without notice.



Salon stbd.



Walk-around deck



Ground tackle



Engine



Electrical/charger



Dyer dinghy

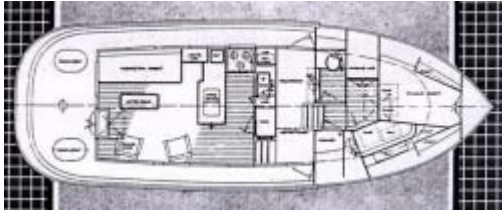

Layout

Last Revised: Jan 31, 2006

Contact The Listing Agent For This Yacht

~ **Greg Haught** ~

At (772) 215-0755 or Email: gregh@stuaryacht.com

Contact [Stuart Yacht](#).

450 SW Salerno Road
Stuart, FL 34997, USA

Tel 772-283-9400
Fax 772-220-7496

[Email Us](#)

Use of this site is subject to our [terms of use](#), which prohibit commercial use of our site. By continuing past this page, you agree to abide

[home](#) | [about us](#) | [advertise with us](#) | [site map](#) | [privacy](#) | [terms of use](#) | [contact us](#) | [help](#)



copyright © 2005 Trader Publishing Company All Rights Reserved.

Main site photos copyright © 2005 **Neil Rabinowitz**.

YachtWorld.com ® since 1995